

A light gray world map is centered in the background of the slide, showing the continents of North America, South America, Europe, Africa, Asia, and Australia.

**Nova Southeastern Institute for Disaster and
Emergency Preparedness**

**EVALUATING THE
IMPLEMENTATION OF PODS FOR
COVID-19 VACCINES AT
AIRPORTS AND UNIQUE VENUES**

Dr. Jesse P. Spearo, CEM, FPEM, FMI

MADE POSSIBLE BY



National Institutes
of Health

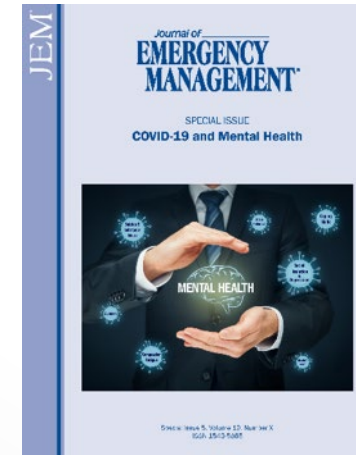

SPECIAL GUEST PANEL



Nora Yotsov, MS, CEM
*Senior Manager of Public
Safety and Security
Port of Portland*



**Andrew Friend, MA,
CEM**
*Deputy Director
Illinois Department of
Public Health*



Larry Mares
*Manager of Emergency
Operations and Planning
San Francisco
International Airport*

OBJECTIVES

1. Thinking Outside the Box. Adapting to expand vaccine points of distribution/dispensing (PODs) beyond what's "In the Plan".
2. Establishing vaccine PODS at unusual sites with less traditional partners.
3. Supporting partner agencies by synergizing efforts and applying evolving best practices.
4. Managing quixotic administrative and community expectations while maintaining unity of effort.

HOW WE GOT HERE

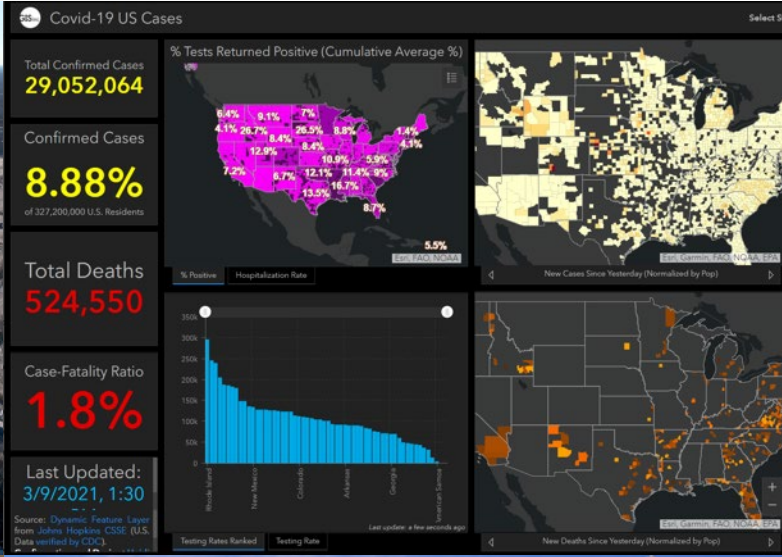

THINKING OUTSIDE THE BOX – BEYOND “THE PLAN”

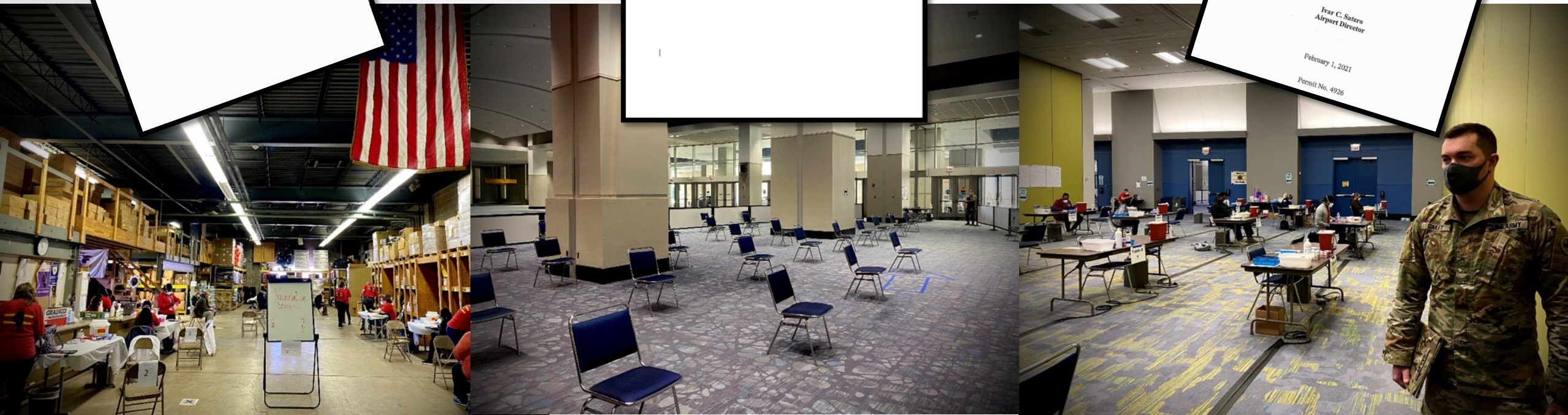
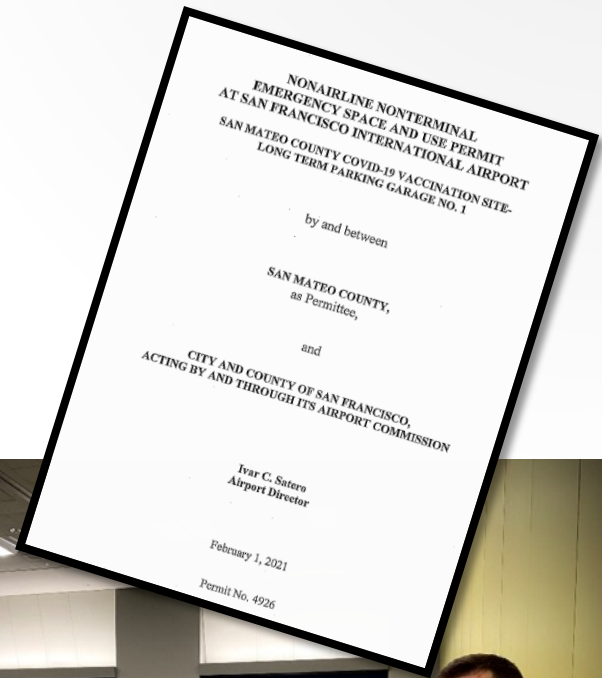
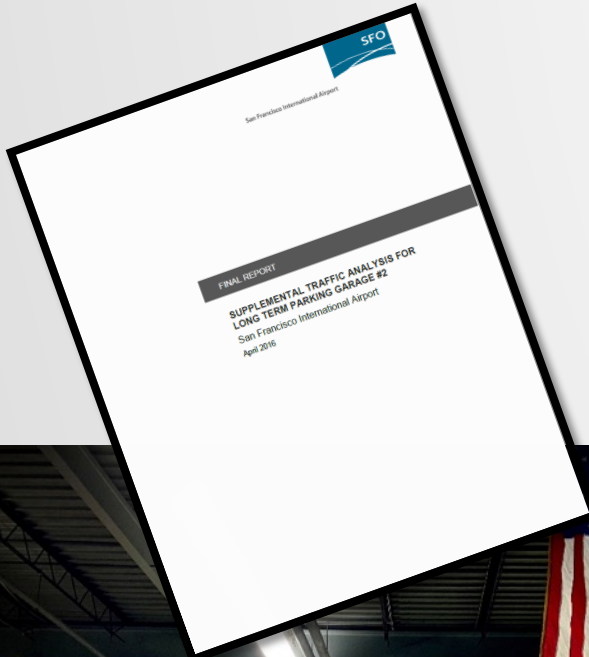

THINKING OUTSIDE THE BOX – BEYOND “THE PLAN”

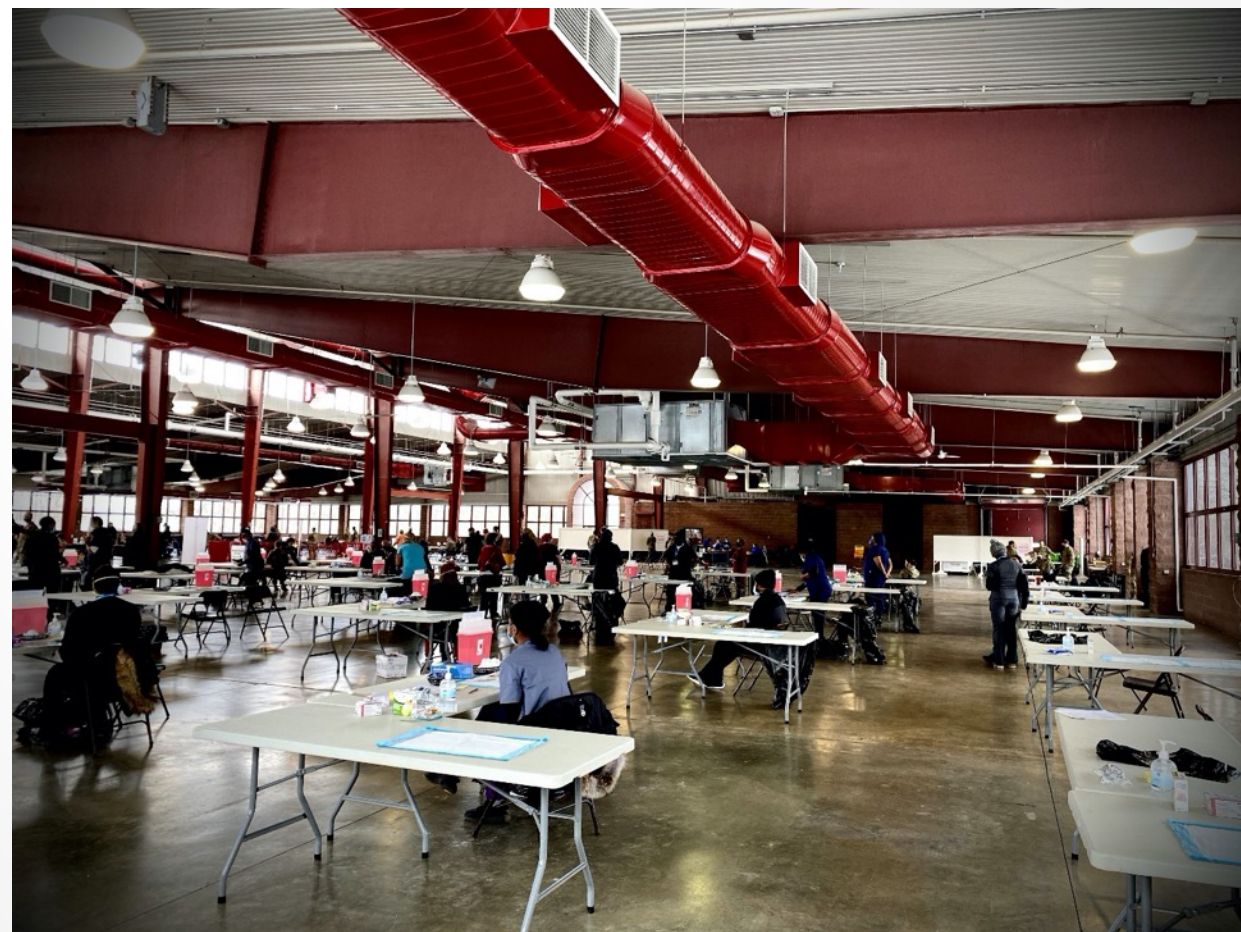

ESTABLISHING PODS AT UNUSUAL SITES WITH LESS TRADITIONAL PARTNERS

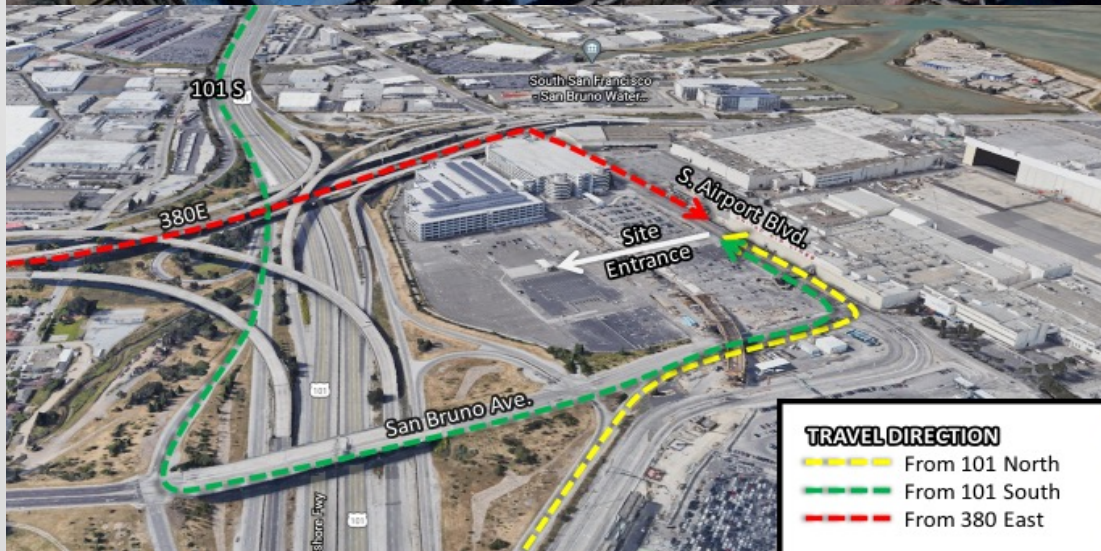

SYNERGIZING – APPLYING BEST PRACTICES



VOLUNTEERS NEEDED

In anticipation of future needs, our Virtual Emergency Volunteer Center (EVC) is currently pre-registering volunteers interested in assisting government staff with COVID-19 vaccinations at Points of Distribution (POD) sites this year. The County of Orange is looking to establish two teams of volunteers willing to serve in these crucial volunteer roles:

- Medical Trained Volunteers •
- General Support Volunteers •

Volunteers, we need your help.
In anticipation of future needs, please register at:
<https://volunteers.oneoc.org/special-event/a1821000007VTf2>

Google Chrome is the best platform for access



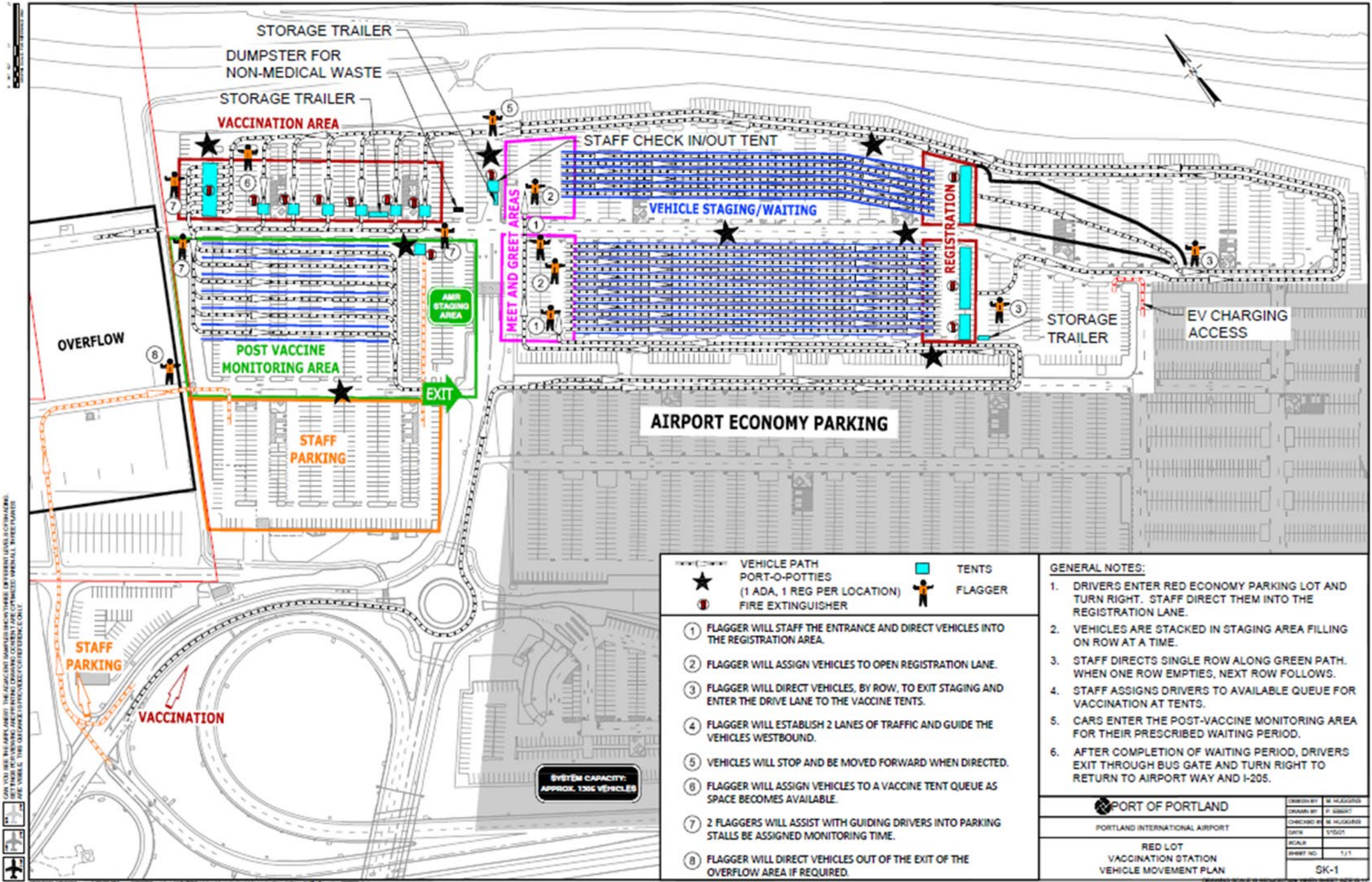

- | | | | |
|---|--|---|---------|
| ★ | VEHICLE PATH
PORT-O-POTTIES
(1 ADA, 1 REG PER LOCATION)
FIRE EXTINGUISHER | ☐ | TENTS |
| 1 | | 👤 | FLAGGER |
- ① FLAGGER WILL STAFF THE ENTRANCE AND DIRECT VEHICLES INTO THE REGISTRATION AREA.
 - ② FLAGGER WILL ASSIGN VEHICLES TO OPEN REGISTRATION LANE.
 - ③ FLAGGER WILL DIRECT VEHICLES, BY ROW, TO EXIT STAGING AND ENTER THE DRIVE LANE TO THE VACCINE TENTS.
 - ④ FLAGGER WILL ESTABLISH 2 LANES OF TRAFFIC AND GUIDE THE VEHICLES WESTBOUND.
 - ⑤ VEHICLES WILL STOP AND BE MOVED FORWARD WHEN DIRECTED.
 - ⑥ FLAGGER WILL ASSIGN VEHICLES TO A VACCINE TENT QUEUE AS SPACE BECOMES AVAILABLE.
 - ⑦ 2 FLAGGERS WILL ASSIST WITH GUIDING DRIVERS INTO PARKING STALLS BE ASSIGNED MONITORING TIME.
 - ⑧ FLAGGER WILL DIRECT VEHICLES OUT OF THE EXIT OF THE OVERFLOW AREA IF REQUIRED.

- GENERAL NOTES:**
1. DRIVERS ENTER RED ECONOMY PARKING LOT AND TURN RIGHT. STAFF DIRECT THEM INTO THE REGISTRATION LANE.
 2. VEHICLES ARE STACKED IN STAGING AREA FILLING ON ROW AT A TIME.
 3. STAFF DIRECTS SINGLE ROW ALONG GREEN PATH. WHEN ONE ROW EMPTIES, NEXT ROW FOLLOWS.
 4. STAFF ASSIGNS DRIVERS TO AVAILABLE QUEUE FOR VACCINATION AT TENTS.
 5. CARS ENTER THE POST-VACCINE MONITORING AREA FOR THEIR PRESCRIBED WAITING PERIOD.
 6. AFTER COMPLETION OF WAITING PERIOD, DRIVERS EXIT THROUGH BUS GATE AND TURN RIGHT TO RETURN TO AIRPORT WAY AND I-205.

PORT OF PORTLAND	DRAWN BY: M. HUGGINS CHECKED BY: M. HUGGINS DATE: 1/15/21
PORTLAND INTERNATIONAL AIRPORT	SCALE: 1/1 SHEET NO. 1/1
RED LOT VACCINATION STATION VEHICLE MOVEMENT PLAN	SK-1

CAN YOU SEE THE PARKING? THE ADJACENT PARKING AREAS HAVE DIFFERENT LEVELS OF VISIBILITY. THIS MEANS THAT SOME VEHICLES MAY BE IN THE OVERFLOW AREA WITHOUT BEING VISIBLE TO THE STAFF. THIS IS WHY THE STAFF WILL BE IN THE OVERFLOW AREA.

SYSTEM CAPACITY:
APPROX. 1300 VEHICLES

1:1
 SCALE
 SHEET NO. 1/1

PDX RED LOT TRAFFIC CONTINGENCY PLAN (TCP)

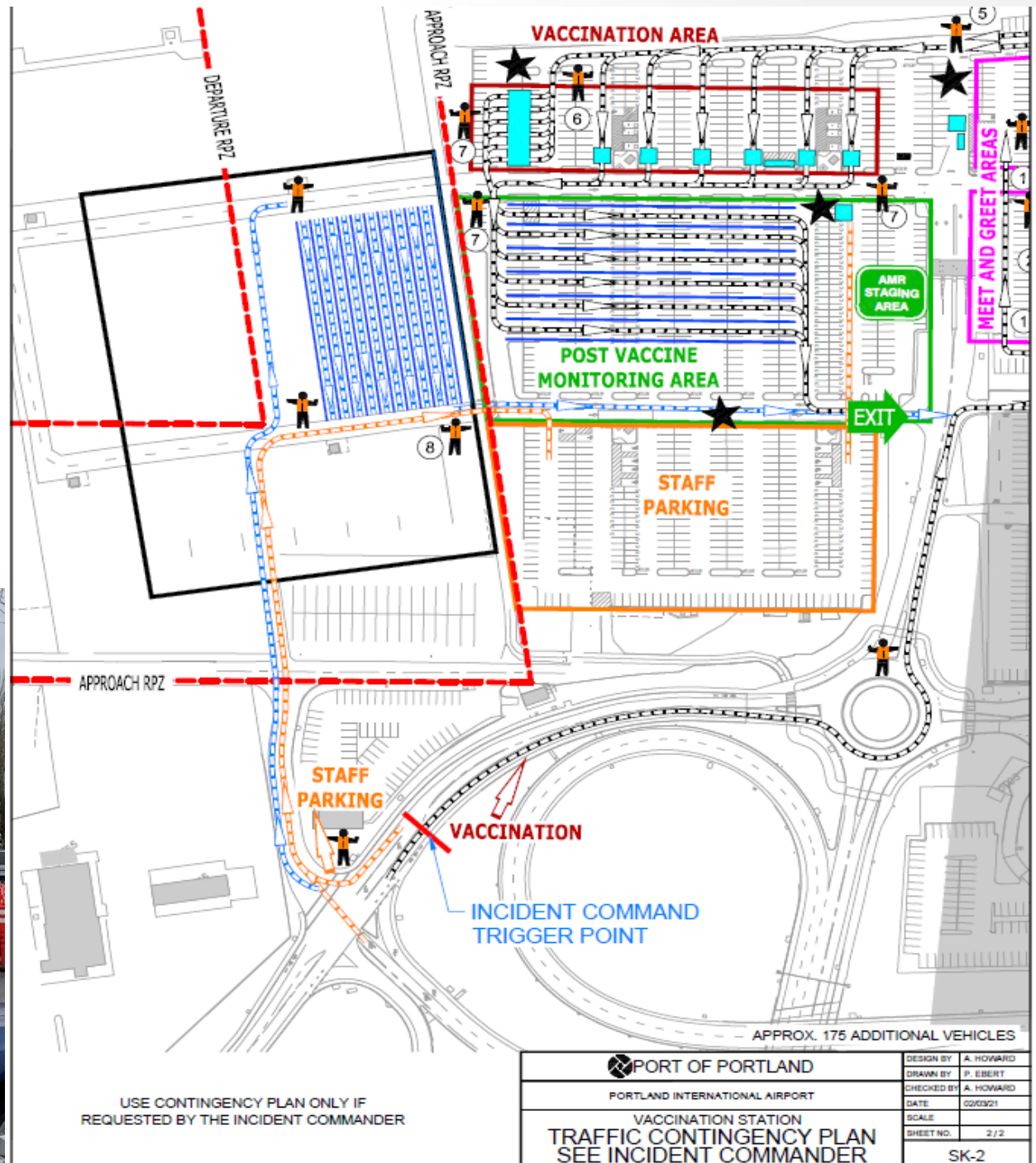

SFO ENTRY & EXIT PLAN

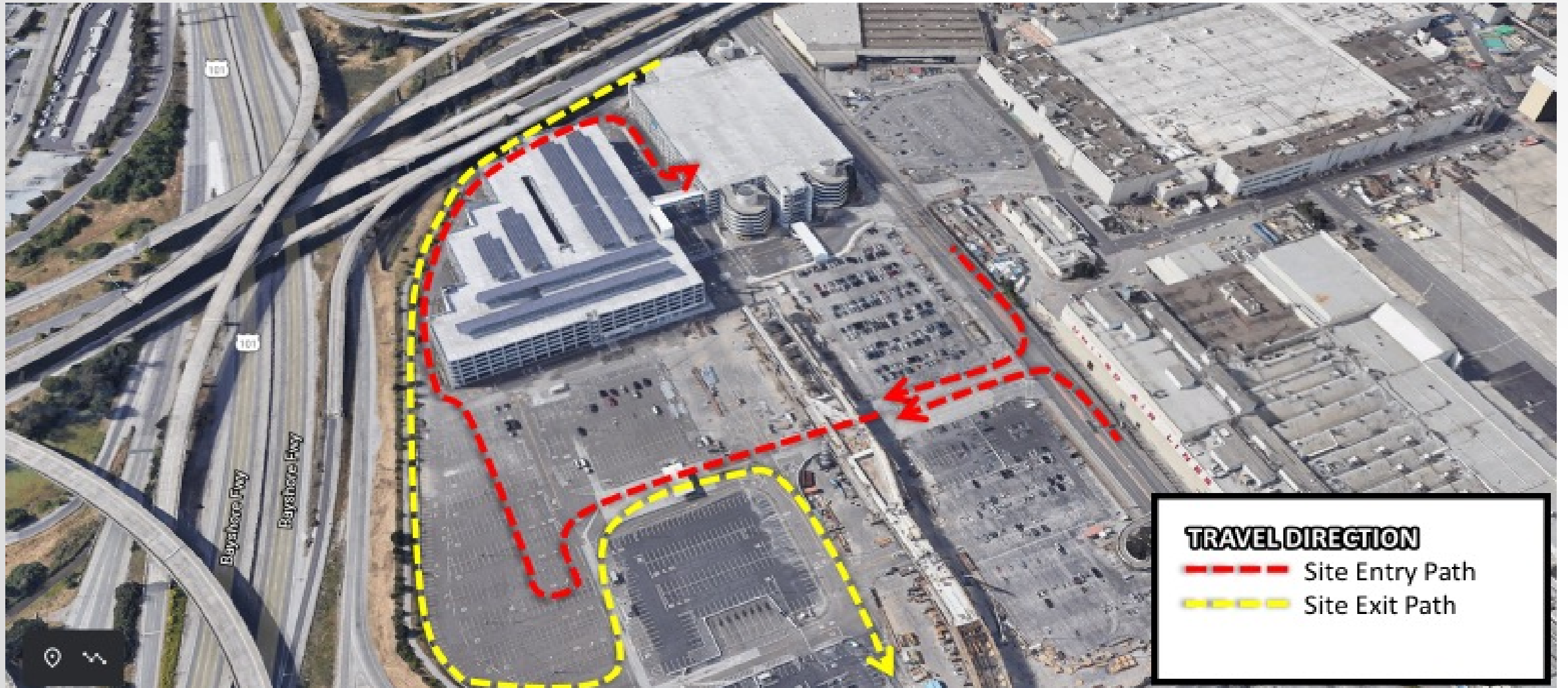

SFO ENTRY & EXIT PLAN

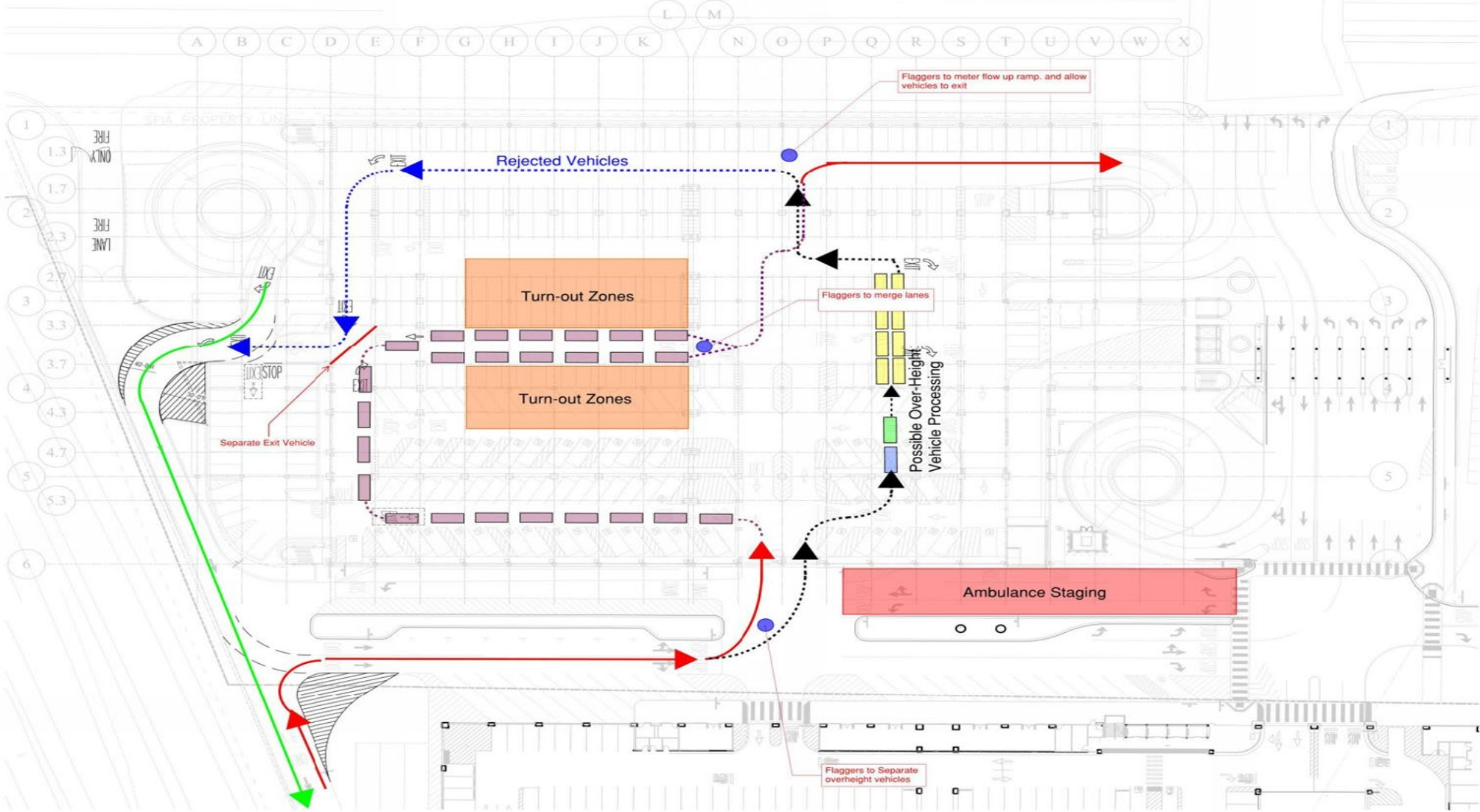

SFO FLOOR LAYOUT

CONCEPT LAYOUT FOR LEVELS 2-6



12 DOCUMENTATION STATIONS -
 ID AND APPOINTMENT VERIFIED AND INITIAL
 VACCINATION RECORD IS CREATED
 **LANE 1 OR LANE A WILL BE DEDICATED FOR HIGH
 RISK PATIENTS

12 VACCINATION STATIONS -
 VACCINATIONS ARE ADMINISTERED IN THIS
 POSITION

120 HEALTH MONITORING POSITIONS -
 UPON COMPLETION OF VACCINE BEING
 ADMINISTERED, PATIENTS WILL NEED TO WAIT 15
 TO ENSURE NO ALLERGIC REACTIONS. IF
 SYMPTOMS OCCUR THEN DRIVERS ARE ADVISED
 TO TURN ON HAZARD LIGHTS AND A MEDIC WILL
 RESPOND. THIS AREA IS CONSTANTLY MONITORED.
 DUE TO HEIGHT LIMITATIONS OF GARAGE,
 AMBULANCES WILL BE STAGED ON LEVEL 1 AND
 STAFF COULD TRANSFER VIA ELEVATOR OR
 BUGGY TO LEVEL 1.

10 HEALTH MONITORING POSITIONS -
 UPON COMPLETION OF VACCINE BEING
 ADMINISTERED, HIGH RISK PATIENTS WILL BE
 MOVED OUT OF LANE A AND TOLD TO WAIT 30
 MINUTES TO ENSURE NO ALLERGIC REACTIONS. IF
 SYMPTOMS OCCUR THEN DRIVERS ARE ADVISED
 TO TURN ON HAZARD LIGHTS AND A MEDIC WILL
 RESPOND. THIS AREA IS CONSTANTLY MONITORED.
 DUE TO HEIGHT LIMITATIONS OF GARAGE,
 AMBULANCES WILL BE STAGED ON LEVEL 1 AND
 STAFF COULD TRANSFER VIA ELEVATOR OR
 BUGGY TO LEVEL 1.

MANAGING QUIXOTIC ADMINISTRATIVE AND COMMUNITY EXPECTATIONS

